



GENERAL DOORS
Corporation



Windemere Model 175
Insulated Steel Garage Doors

**Carriage House Style Doors
with an Energy Efficient R-16 Rating**

World Class Quality
Local Availability

Windemere Model 175 Insulated Steel Garage Doors

The Windemere Model 175 offers homeowners with a climate controlled garage the timeless look of carriage house doors, one of the industry's highest insulation values, and the strength and practicality of pre-finished steel. This is a premium, highly energy efficient door featuring a calculated insulation value of R-16.

Three layer construction with a CFC-free polyurethane core and full 26 gauge G-60 galvanized steel skins inside and outside

- 1-3/4" thick steel sandwich construction using a polyurethane insulating core with an R-value of 16
- Durable two-coat baked-on polyester paint finish on both sides of door
- Stamped V-groove panel for carriage house door design
- Sections have a thermal break and dual weather seal between them for tight closure and energy efficiency
- Three-year hardware warranty
- Limited lifetime warranty against rust-through or delamination of door sections

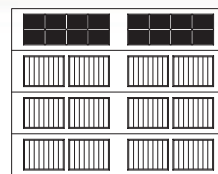

8', 9', and 10' Wide Doors

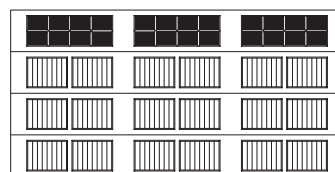

12' Wide Doors

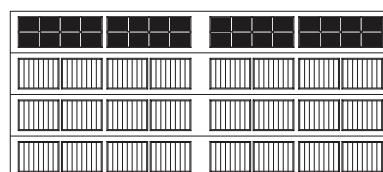

16' and 18' Wide Doors
Odd Size Not Available

Here's why we can offer a "Lifetime Rust-Through Warranty"

A standard feature of The Windemere 175 is our tough, anti-corrosion protection – inside and out.

- 1-3/4" thick Polyurethane (100% CFC-free) Inner Core
- Base Steel
- Hot-dipped Zinc Coat (Galvanized)
- Primer Coat
- Baked-on Polyester Top Coat

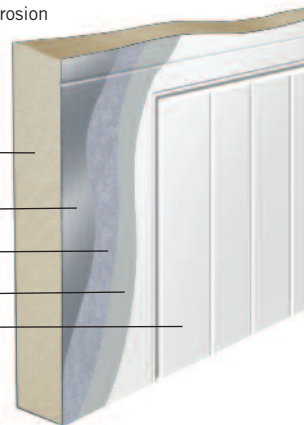



Door Colors

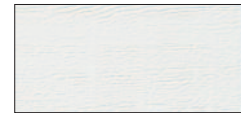

ARCTIC WHITE



ALMOND

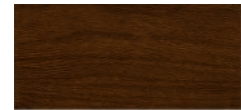

DEEP BROWN



SANDTONE

Windemere 175 is available in four color choices. Although doors should not need repainting, if a custom color is required, our paint system provides an excellent base for any field applied paint.

WINDOW OPTIONS

General Doors' Windemere 175 doors are available with either two windows (long panel) or four windows (short panel), plus several distinctive design trim styles that work with a variety of architecture. Wider doors have different layouts. Color matched frames and design trim inserts that snap-in and snap-out for easy glass cleaning are standard. Windemere 175 windows are insulated glass only.



591 Cascade Short Panel



591 Cascade Long Panel



397 Colonial Short Panel



397 Colonial Long Panel

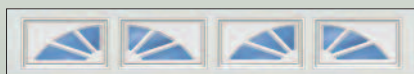

306 Sherwood Short Panel



306 Sherwood Long Panel



305 Sunburst Short Panel



305 Sunburst Long Panel



320 Waterton Short Panel



320 Waterton Long Panel



393 Cathedral Short Panel



387 Stockton Long Panel



388 Somerton Long Panel



588 Wynbridge Long Panel



Decorative Hardware

General Doors' decorative hardware is an ideal way to customize a Windemere door. Inspired by antique carriage door hardware and available in wrought iron or flat black, this finishing touch can transform the look of any door and even the look of your home.

There's a Windemere 175 Door for Every Garage



Weather-tight section joint is a 3/8" deep ship lap joint with dual, between-section seal

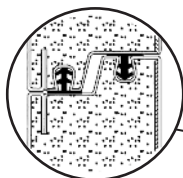

Finely detailed V-Groove Carriage House style panels

Continuous process polyurethane insulating core R-16

Continuous steel reinforcement strip for hardware attachment

Flexible 3" vinyl bottom seal in aluminum retainer

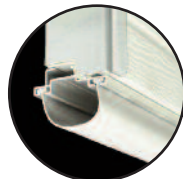

Lifetime limited warranty against rust-through and/or delamination of door face. See dealer for complete warranty information.

Green Building Benefits

Energy savings from insulation value, recycled content, and product longevity.



1 Monroe Street
PO Box 205 • Bristol, PA 19007-0205
215.788.9277 • Fax: 215.788.9450
general-doors.com
sales@general-doors.com

GENERAL DOORS
Corporation

Your Authorized General Doors Distributor:

